

LUBRICATE ALL SEALS WITH CLEAN HYDRAULIC OIL PRIOR TO ASSEMBLY. DO NOT USE SILICONE BASED LUBRICANTS.

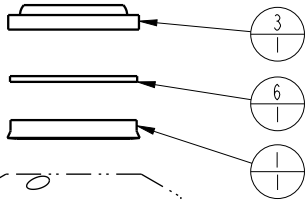

INSTALL WITH LIPS DOWN

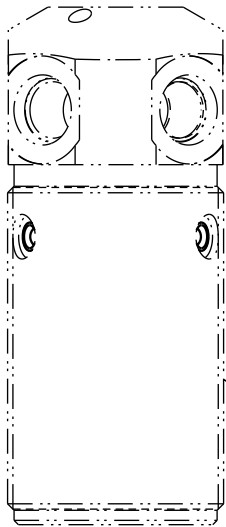

BODY, NOT A REPLACEMENT PART

T-SEAL INSTALLATION INFO

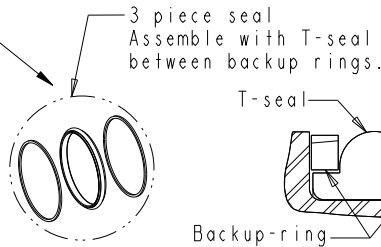
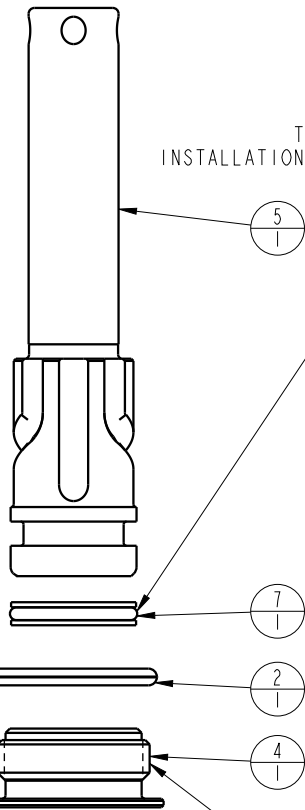

N/A	N/A	60250209	KIT, SEAL, FKM	N/A	NOTED
N/A	N/A	6V250209	KIT, SEAL, STANDARD	NOTED	N/A
7	1	39H10018	SEAL,T, (11/16 X 5/32 X 7/8)	X	39V10018
6	1	39F54001	BU RING, (-208 CUSTOM)	X	39F54001
5	1	81510901	PLUNGER, SC, 1100#		
4	1	81400029	RETAINER, SC, HS, 1100		
3	1	39053001	WIPER, SNAP-IN, (5/8)	X	39053001
2	1	39051031	O-RING, (-912)	X	39051031
1	1	39010020	SEAL,BEVEL W/HEEL INSERT,5/8 x 1/8 x 7/8	X	39V10020
No.	QTY	PART No.	DESCRIPTION	STANDARD SEAL KIT	FKM SEAL KIT

TIGHTEN TO 30 FT-LBS TORQUE.

WEIGHT 1.69 LBS

PARTS LIST



VEKTEK, INC.
1334 E. SIXTH AVE. P.O. BOX 625
EMPORIA, KS. 66801 U.S.A.

ASSEMBLIES AFFECTED
25020909
25020909F

PARTS LIST, ASSY,CYL,PP,TB,3000/1400

SIZE A PL2516

REV B

B	5814	RELEASE	JDW	09/18/25
REV	IN ACCORDANCE WITH ECN	EFFECTIVE DATE	REVISED BY	DATE
DRW BY: NPETERS	DRAWING STATUS: Released			
DATE: 5/13/21	PRODUCTION APPROVED FOR RELEASED STATUS ONLY			

FORM FEG035_PL_ASIZE, REV. B

SHEET 1 OF 1